



US008203850B2

(12) **United States Patent**
Bouza, II et al.

(10) **Patent No.:** **US 8,203,850 B2**
(45) **Date of Patent:** **Jun. 19, 2012**

(54) **ANTI-EAVESDROPPING DEVICE**

(56) **References Cited**

(75) Inventors: **Jose M. Bouza, II**, Bumpass, VA (US);
Salvador Aguirre, Jr., Arlington, VA
(US); **Daniel Ashley McDonnell**, Laurel,
MD (US); **Timothy Wayne Eaton**,
Centreville, VA (US); **Stephen Robert**
Woodruff, Elkridge, MD (US); **Frank**
Augustine Mason, Arlington, VA (US)

(73) Assignee: **Vector Technologies, LLC**, Fairfax, VA
(US)

(*) Notice: Subject to any disclaimer, the term of this
patent is extended or adjusted under 35
U.S.C. 154(b) by 1171 days.

U.S. PATENT DOCUMENTS

1,765,443	A	6/1930	Peterson
2,757,225	A	7/1956	Dunn
3,055,969	A	9/1963	Schaller, Jr.
3,213,199	A	10/1965	Snow
3,247,312	A	4/1966	Alessi
3,334,175	A	8/1967	Vincent
3,531,577	A	9/1970	Garlington
4,185,167	A	1/1980	Cunningham et al.
4,567,317	A	1/1986	Ehrlich et al.
4,691,483	A	9/1987	Anderson
4,761,921	A	8/1988	Nelson
4,829,729	A	5/1989	Derner et al.
4,972,469	A	11/1990	Saltwick et al.
4,980,516	A	12/1990	Nakagawa
5,039,826	A	8/1991	Newland

(Continued)

(21) Appl. No.: **12/026,519**

FOREIGN PATENT DOCUMENTS

CN 200944923 Y 9/2007

(22) Filed: **Feb. 5, 2008**

(Continued)

(65) **Prior Publication Data**
US 2008/0317265 A1 Dec. 25, 2008

OTHER PUBLICATIONS

McKinney, Jr., J.A., Your demand letter of Aug. 22, 2011 on pending
U.S. Appl. No. 12/026,519, filed Aug. 25, 2011, pp. 5-6.

(51) **Int. Cl.**
H05K 7/14 (2006.01)
H05K 7/18 (2006.01)

Primary Examiner — Hung S Bui

(74) *Attorney, Agent, or Firm* — Lowe Hauptman Ham &
Berner, LLP

(52) **U.S. Cl.** **361/800; 361/799; 361/730**

(57) **ABSTRACT**

(58) **Field of Classification Search** 361/728-730,
361/752, 800, 816, 818, 799; 174/100, 366,
174/367, 35 R, 35 MS, 35 GC, 377; 713/150,
713/162, 163, 168, 171, 182, 189, 194; 380/44,
380/47, 255, 270, 273, 277, 278, 282; 340/1.1,
340/5.1, 5.8, 5.81, 5, 85, 500, 540, 657, 658;
455/39, 67.11, 67.12, 130, 227, 226.1, 226.4

An anti-eavesdropping device is described. The device comprises a receiving compartment for receiving an electronic device, a noise generator, and an EMI filter. The receiving compartment is sealable to minimize signal emissions from the interior to the exterior and from the exterior to the interior, and the noise generator is coupled with the receiving compartment and the EMI filter. The EMI filter is operatively coupled with the noise generator.

See application file for complete search history.

22 Claims, 9 Drawing Sheets

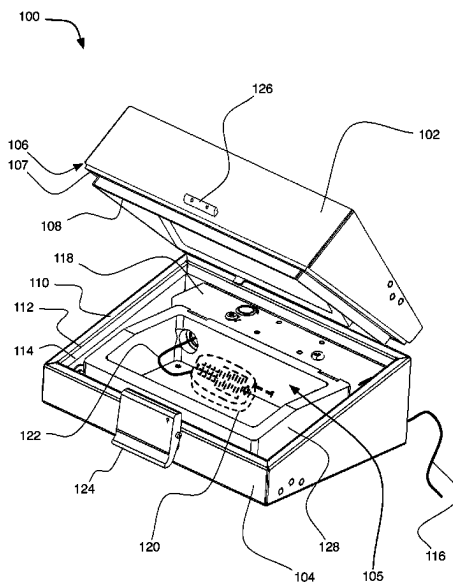

US 8,203,850 B2

U.S. PATENT DOCUMENTS

5,136,119 A 8/1992 Leyland
5,177,785 A 1/1993 Itani et al.
5,194,691 A 3/1993 McIlwraith
5,197,098 A 3/1993 Drapeau
5,239,792 A 8/1993 Avni
5,243,648 A 9/1993 Gilardi et al.
5,444,778 A 8/1995 Bucalo et al.
5,454,037 A 9/1995 Pacella
5,533,131 A * 7/1996 Kury 381/77
5,545,844 A 8/1996 Plummer, III et al.
5,581,047 A 12/1996 Lazaroff
5,586,168 A 12/1996 Bucalo et al.
5,594,200 A 1/1997 Ramsey
6,087,952 A 7/2000 Prabhakaran
6,188,771 B1 2/2001 Horrall
6,195,529 B1 2/2001 Linz et al.
6,272,226 B1 8/2001 Khan et al.
6,377,038 B1 4/2002 Boswell et al.
6,393,254 B1 5/2002 Pousada Carballo et al.
6,469,495 B1 10/2002 Boswell et al.
6,545,459 B2 4/2003 Boswell et al.
6,563,297 B1 5/2003 Boswell et al.
6,580,372 B1 6/2003 Harris
6,657,214 B1 12/2003 Foegelle et al.
6,798,887 B1 9/2004 Andre

7,065,655 B1 6/2006 Jakobsson
7,075,798 B2 7/2006 Hendrickson
7,202,798 B2 4/2007 Harris
7,302,234 B1 11/2007 Fessler et al.
7,342,184 B2 3/2008 Cochrane
7,388,160 B2 6/2008 Mok et al.
7,512,430 B2 3/2009 Nakamura
7,601,921 B2 10/2009 Schroader
7,709,749 B2 5/2010 Meier
7,736,312 B2 * 6/2010 Taylor et al. 600/437
2002/0175099 A1 11/2002 Wu
2003/0057131 A1 3/2003 Diaferia
2004/0183547 A1 9/2004 Kildal
2005/0028999 A1 2/2005 Leu et al.
2005/0092504 A1 5/2005 Walthall et al.
2006/0260838 A1 11/2006 Ariel
2007/0034406 A1 2/2007 Schroader
2007/0142103 A1 6/2007 Livne

FOREIGN PATENT DOCUMENTS

GB 1549593 A 2/1978
JP 2004329818 A 11/2004
JP 2009164265 A 7/2009
JP 2009224446 A 10/2009
WO WO 99/44321 9/1999

* cited by examiner



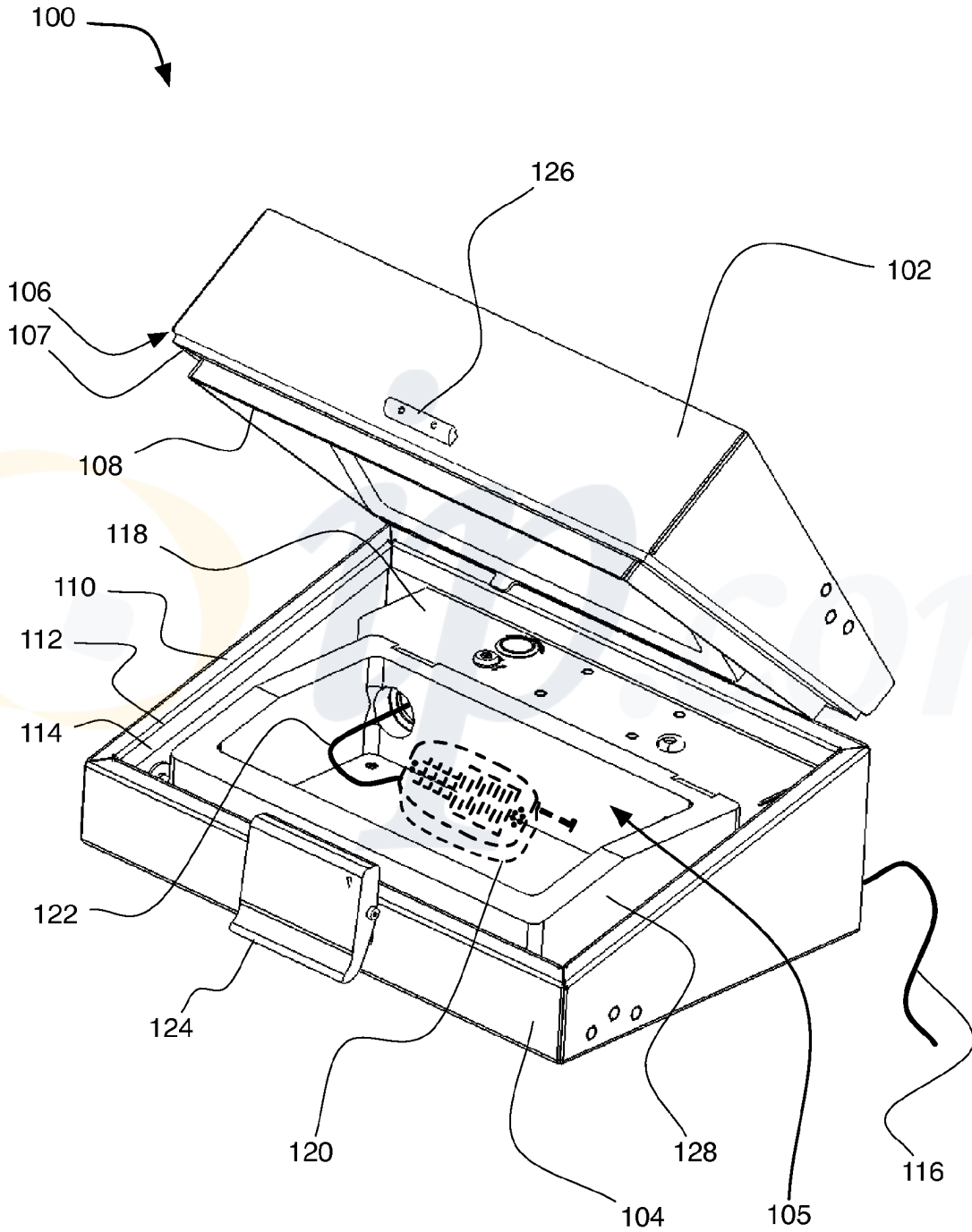

FIG. 1

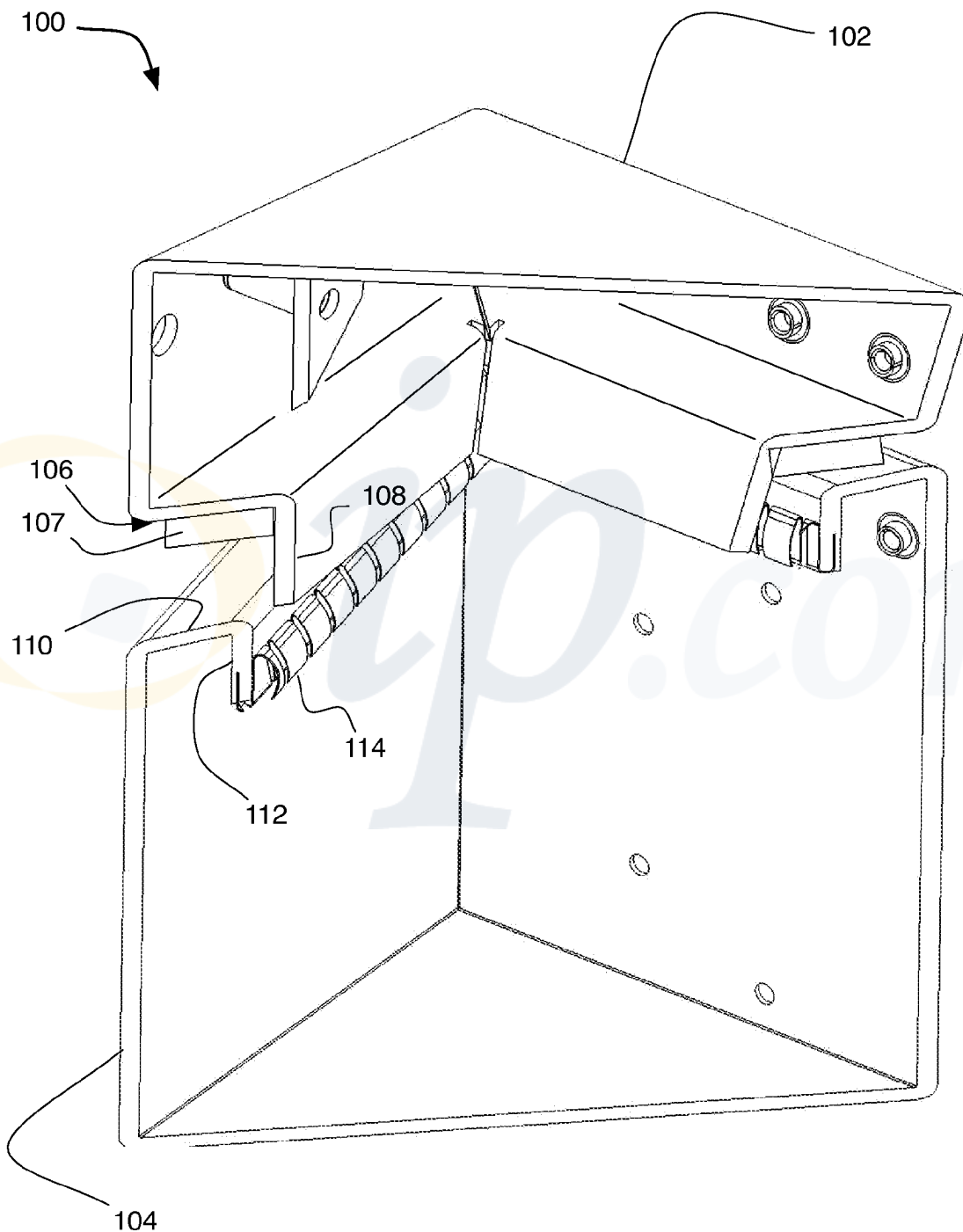

FIG. 1A

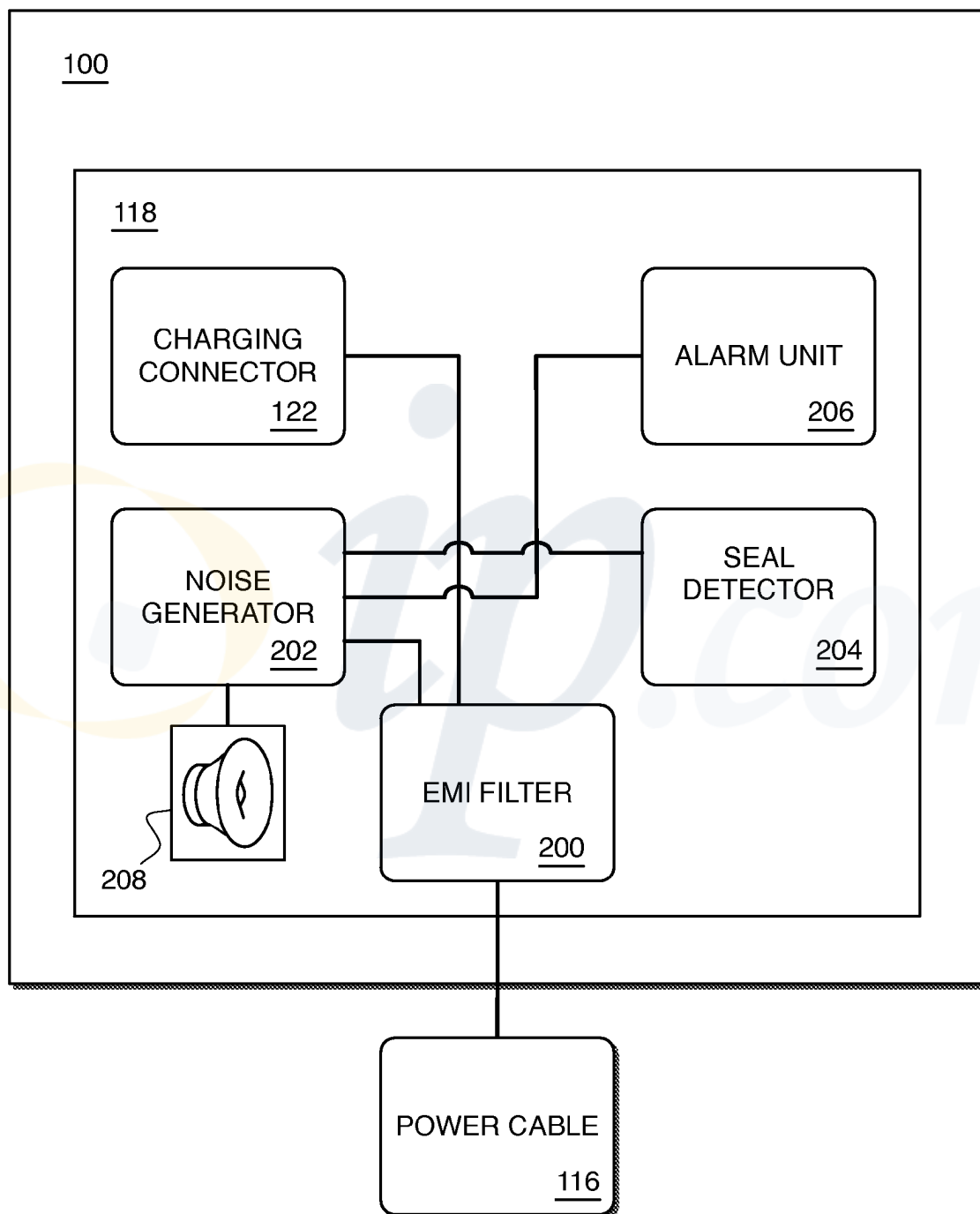

FIG. 2

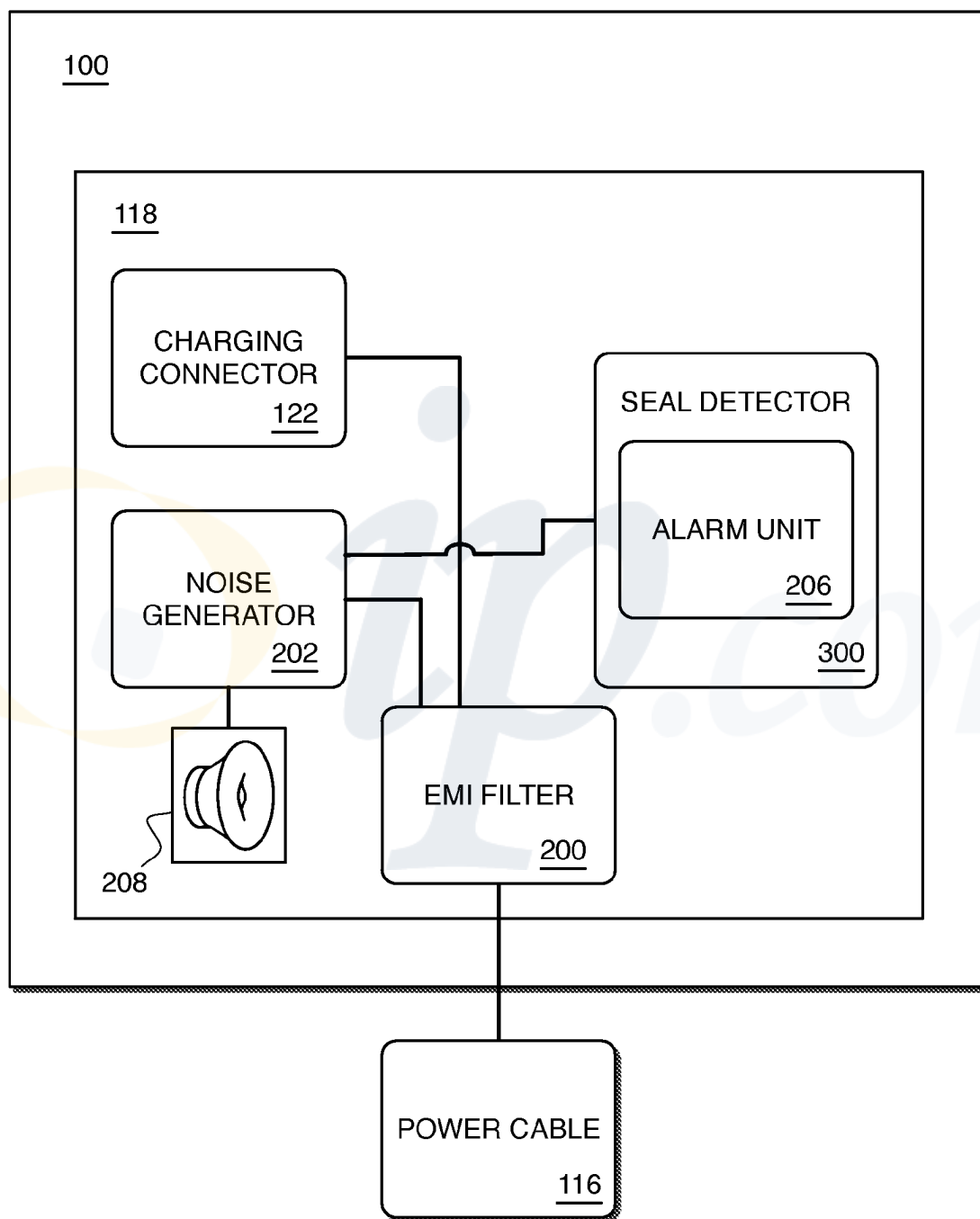

FIG. 3

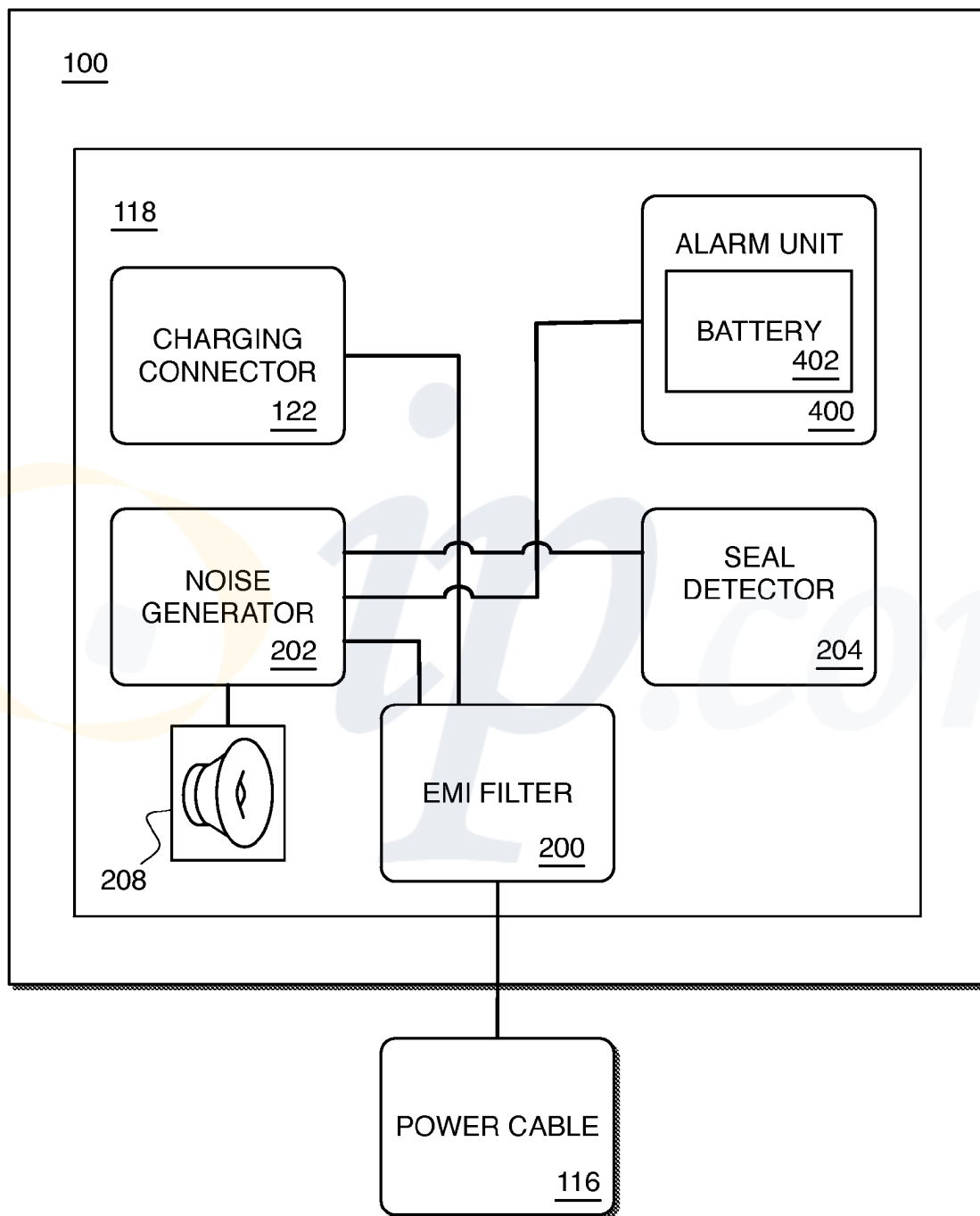

FIG. 4

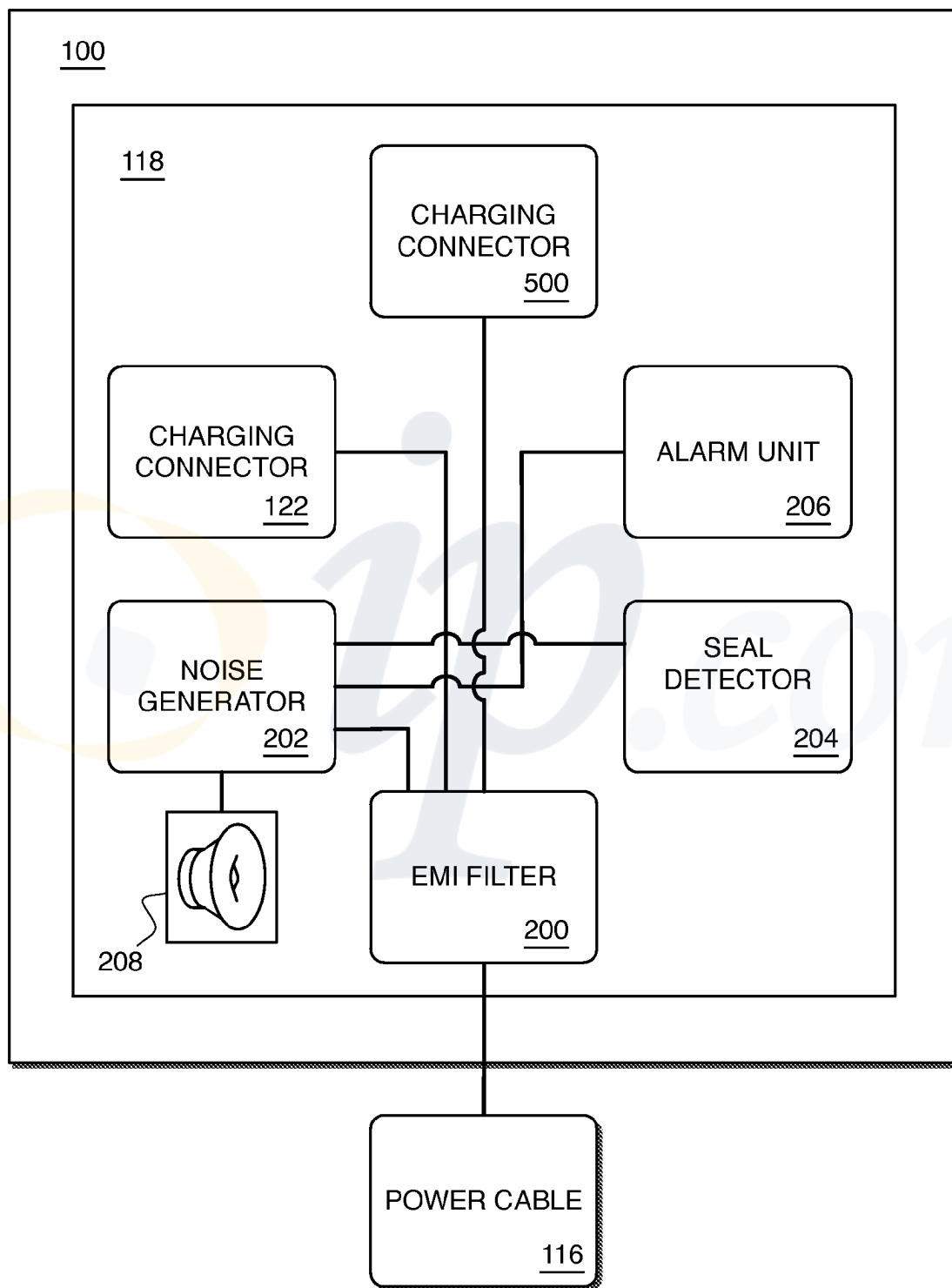

FIG. 5

600

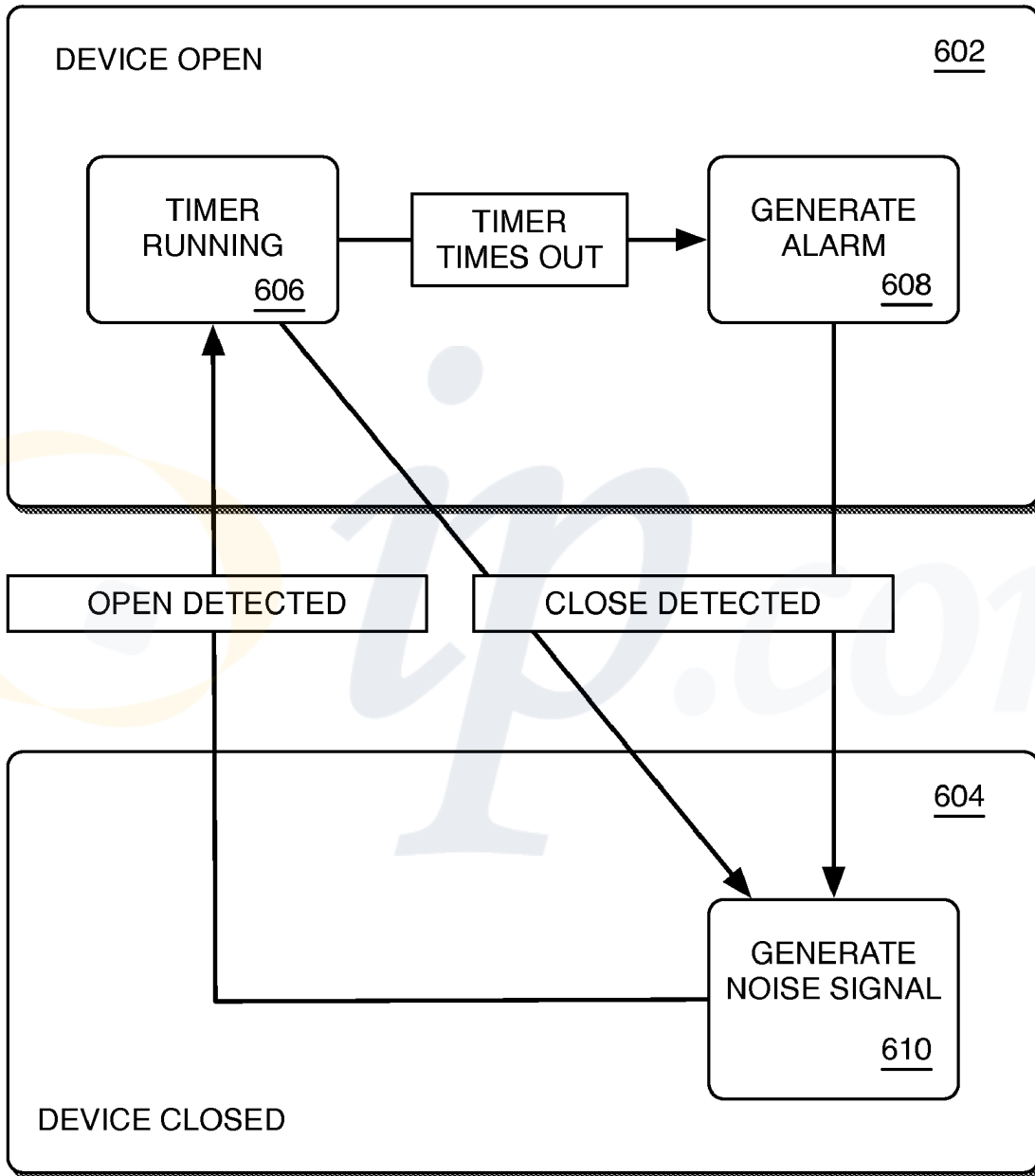

FIG. 6

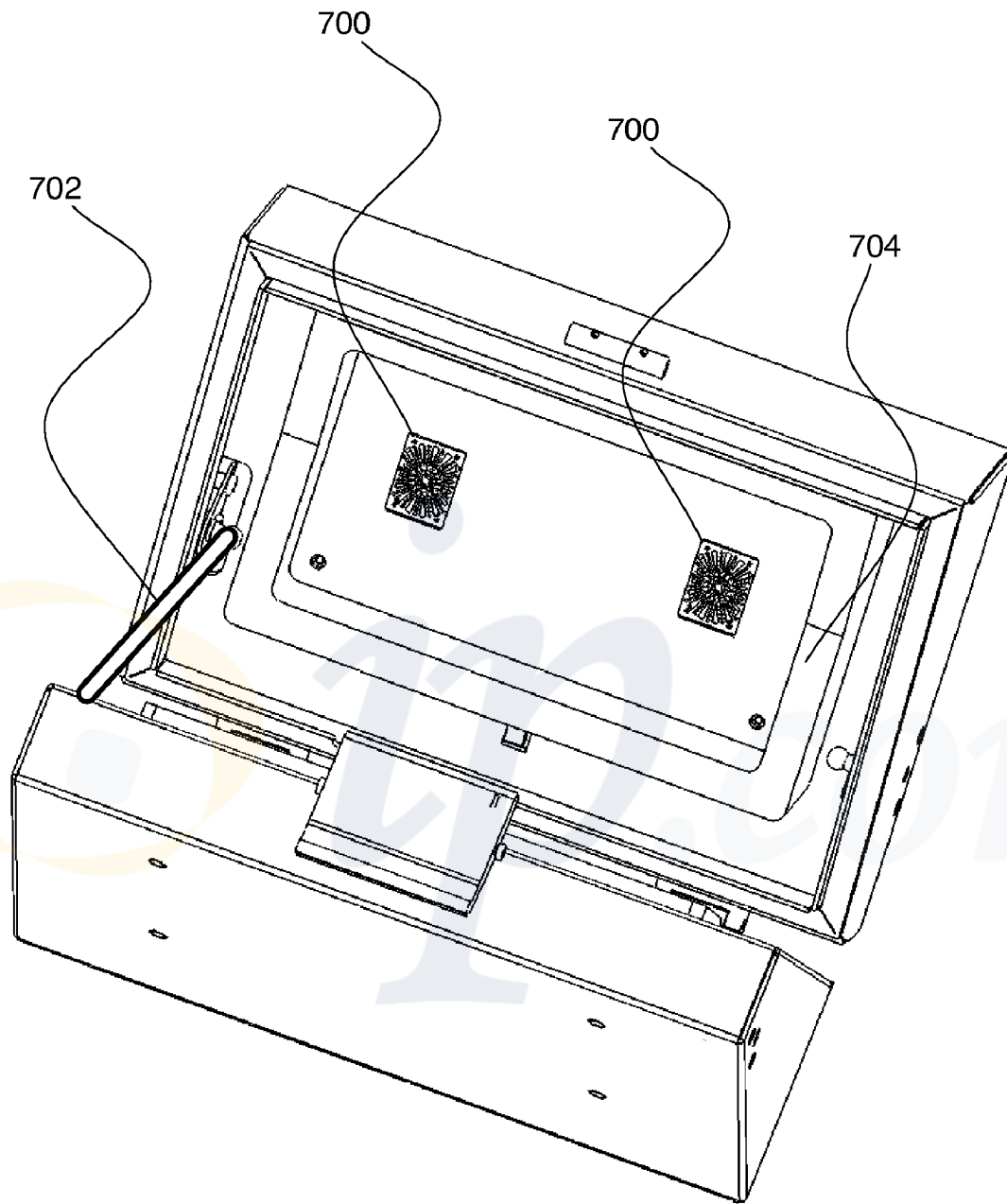

FIG. 7

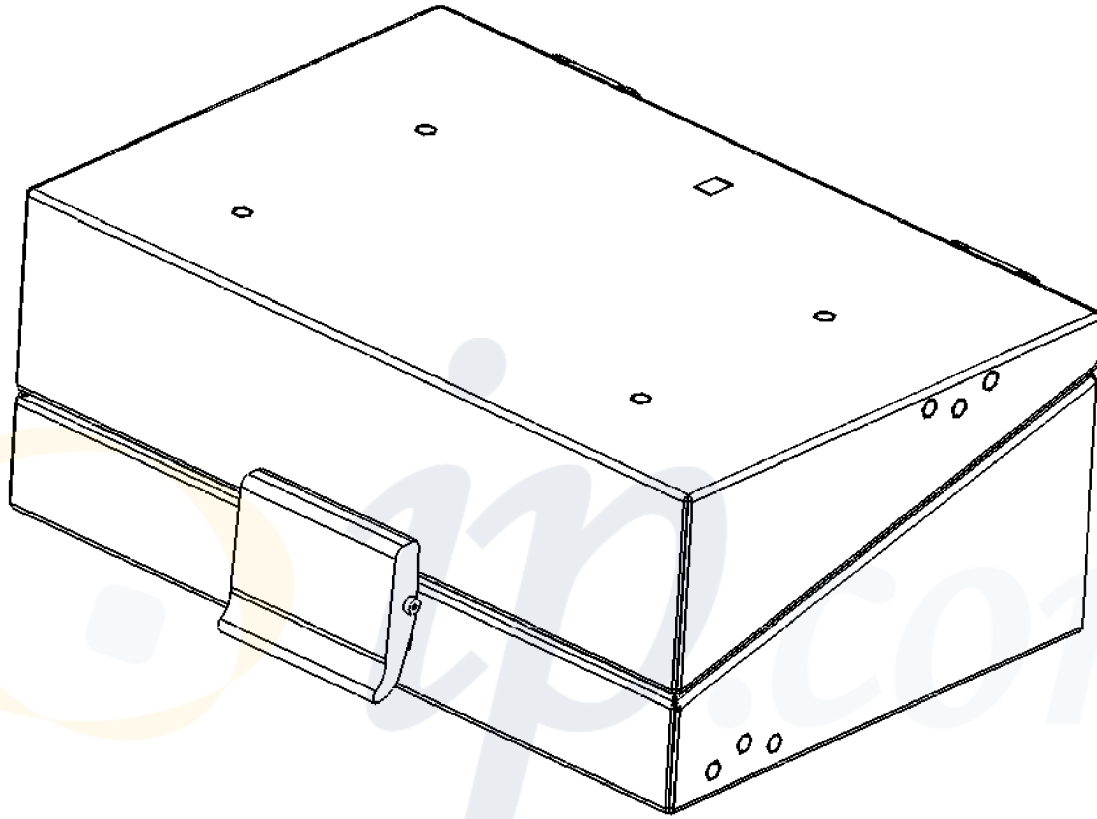

FIG. 8

1

ANTI-EAVESDROPPING DEVICE

BACKGROUND

Many portable electronic devices today contain relatively high fidelity microphones, high resolution cameras and multiple types of radio frequency transmission capabilities.

DESCRIPTION OF THE DRAWINGS

One or more embodiments is illustrated by way of example, and not by limitation, in the figures of the accompanying drawings, wherein elements having the same reference numeral designations represent like elements throughout and wherein:

FIG. 1 is a perspective view of an anti-eavesdropping device according to an embodiment;

FIG. 1A is a detailed perspective view of a portion of the anti-eavesdropping device of FIG. 1;

FIG. 2 is a high-level functional block diagram of an anti-eavesdropping device according to an embodiment;

FIG. 3 is a high-level functional block diagram of an anti-eavesdropping device according to another embodiment;

FIG. 4 is a high-level functional block diagram of an anti-eavesdropping device according to another embodiment;

FIG. 5 is a high-level functional block diagram of an anti-eavesdropping device according to another embodiment;

FIG. 6 is a high-level process flow diagram of a portion of operation of an anti-eavesdropping device according to an embodiment;

FIG. 7 is a perspective view of an anti-eavesdropping device according to an embodiment; and

FIG. 8 is a perspective view of an anti-eavesdropping device according to an embodiment in a closed state.

DETAILED DESCRIPTION

FIG. 1 depicts a perspective view of an anti-eavesdropping device 100 according to an embodiment. Device 100 comprises a top portion (or lid) 102 movably coupled with a bottom portion (or base) 104 thereby forming a receiving compartment 105 for receiving an electronic device. In at least some embodiments, a hinge connects top portion 102 with bottom portion 104. Top portion 102 and bottom portion 104 are each comprised of a signal blocking material. In at least some embodiments, the signal blocking material prevents and/or minimizes the transmission of acoustic and/or electromagnetic signals from the exterior of device 100 to the interior. In at least some embodiments, the signal blocking material prevents and/or minimizes the transmission of acoustic and/or electromagnetic signals from the interior to the exterior.

Lid 102 forms a parallelepiped having at least one face substantially open to the interior of the lid, i.e., lid forms a five-sided box having a sixth open end. In at least some embodiments, lid 102 may be formed of other shapes having more or less number of sides and/or non-parallel sides. In at least some embodiments, lid 102 is formed by bending a metal or alloy-based material to form an open-ended box. In at least some embodiments, lid 102 comprises a 0.093 gauge thick aluminum alloy 5052-H32. In at least some embodiments, lid 102 comprises an electrically conductive material.

Along the perimeter of the open end of lid 102, the lid is bent inward to form a return flange 106. Along the perimeter of return flange 106, lid 102 is bent away from the opening to form a knife edge 108. Knife edge 108 forms a contact point for contacting a corresponding perimeter piece attached to

2

base 104. In at least some embodiments, the corresponding perimeter piece may be formed as an integrated part of base 104. After 102 is formed, the lid may be welded or otherwise constructed, e.g., extrusion, etc. to ensure an electromagnetic interference (EMI) seal. In at least some embodiments (and as depicted in FIG. 1), an EMI gasket 107 is affixed to return flange 106. EMI gasket 107 may comprise an electrically conductive material. In at least some embodiments, lid 102 may be painted in areas where no EMI gasket 107 makes contact.

Similar to lid 102, base 104 forms a parallelepiped having at least one face substantially open to the interior of the base, i.e., the base forms a five-sided box having a sixth open end. In at least some embodiments, base 104 may be formed of other shapes having more or less number of sides and/or non-parallel sides. In at least some embodiments, base 104 is formed by bending a metal or alloy-based material to form an open-ended box. In at least some embodiments, base 104 comprises a 0.093 gauge thick aluminum alloy 5052-H32. In at least some embodiments, base 104 comprises an electrically conductive material.

Further similar to lid 102, along the perimeter of the open end of base 104, the base is bent inward to form a return flange 110. Along the perimeter of return flange 110, base 104 is bent toward the bottom of the base to form a knife edge 112. EMI finger stock 114 is attached along knife edge 112 for contacting knife edge 108 of lid 102. In at least some embodiments, finger stock 114 may be formed as an integrated part of base 104. After base 104 is formed, the base is welded or otherwise constructed to ensure an EMI seal. Base 104 may be painted in areas where no EMI gasket 107 makes contact. In at least some embodiments, return flange 110 may comprise an EMI gasket affixed thereto.

In at least some embodiments, device 100 is 15.50 inches wide, 10.25 inches deep and 8.50 inches tall when fully assembled, i.e., lid 102 closed against base 104 with knife edge 108 inserted into contact with finger stock 114. In at least some embodiments, device 100 weighs 15.25 pounds.

A power adapter (transformer) external to device 100 is configured to supply one or more predetermined levels of power, e.g., current and/or voltage levels, to the device. The power adapter receives power, i.e., current, via a power source and transmits power to device 100 by way of power cable 116.

In at least some embodiments, the power adapter transforms an alternating current (AC) input of 100-240 Volts AC (VAC) at 1.6 Amps, 50/60 Hz to a single +12 Volts direct current (VDC) output at 5 Amps. The transformed power is supplied to generation and suppression unit 118 positioned in the interior of device 100. In at least some embodiments, unit 118 incorporates a transformer as an integrated portion inside device 100. In at least one embodiment with an integrated transformer, power cable 116 may be eliminated.

Unit 118 is arranged to supply power (current) to at least one electronic device 120 positioned inside device 100 and electrically coupled via a charging connector 122 to the unit to receive charging power. In at least some embodiments, device 100 is arranged to accommodate more than one electronic device 120 within the interior and unit 118 is arranged to supply a charging current to more than one electronic device 120. In at least some further embodiments, unit 118 may be arranged to supply a charging current to the number of electronic devices 120 accommodated in the interior of device 100. Electronic device 120 may comprise an electronic device having a microphone and/or speaker (transducer) and a recording and/or a transmitting capability. In at least some embodiments, electronic device 120 may comprise a personal digital assistant, a cellular or other wireless telephonic device,

a digital and/or analog recorder, etc. Charging connector **122** is configured to supply a charging current to electronic device **120** and may be configured for one or more particular electronic devices.

In at least some embodiments, lid **102** is biased with respect to base **104** to remain in an open position. In accordance with these embodiments, device **100** further comprises a latch assembly comprising a latch **124** attached to base **104** and biased to a closed position, e.g., through the use of a coil spring to provide torque to keep the latch in a closed position. A corresponding catch **126** is mounted on lid **102** for engaging with latch **124**. In at least some embodiments, latch **124** may be constructed of 6061-T6 aluminum alloy. In at least some embodiments, catch **126** may be constructed of 303 stainless steel. In operation, as lid **102** is moved downward toward base **104**, the lid interfaces with catch **126**. Catch **126** urges latch **124** away from lid **102**. After catch **126** clears a leading edge of latch **124**, the latch returns to the closed position and the catch is secured via an undercut in the latch.

FIG. 1 further depicts a lower portion of an isolation material **128** positioned within base **104** for receiving electronic device **120** and further isolating the device from audio signals from exterior of device **100**. In at least some embodiments, isolation material **128** may comprise a foam or other cushioning material to protect electronic device **120**, e.g., a cross-linked polyethylene foam.

FIG. 1A depicts an enlarged view of a portion of device **100** in a slightly open configuration. FIG. 1A depicts lid **102** in a partially-open configuration depicting EMI gasket **107** affixed to a surface of return flange **106** of the lid. FIG. 1A also depicts knife edge **108** of lid **102** contacting a portion of finger stock **114** affixed to knife edge **112** of base **104**. In at least some other embodiments, finger stock **114** may comprise one or more different configurations comprising greater or fewer numbers of finger for contact with knife edge **108** of lid **102**. In at least some other embodiments, finger stock **114** may be attached to knife edge **108** of lid **102**.

FIG. 2 depicts a high-level functional block diagram of at least a portion of generation and suppression unit **118** of device **100** according to an embodiment in which the unit comprises an electromagnetic interference (EMI) filter **200** (electromagnetic signal filter), a noise generator **202**, charging connector **122**, a seal detector **204**, an alarm unit **206**, and a speaker **208**.

EMI filter **200** electrically couples the power supplied to unit **118** and the components thereof and to the remaining components of device **100** via power cable **116** and filters the received power signal to permit selected frequency ranges to be communicated to/from device **100**. In at least some embodiments, EMI filter **200** blocks frequencies other than those permitted ranges, e.g., the EMI filter blocks all frequencies other than the permitted frequencies. In at least some embodiments, EMI filter **200** is attached, i.e., grounded, to one or the other of lid **102** or base **104** to keep unwanted emissions from going into or out of device **100**. EMI filter **200** may be used to only permit selected frequency ranges through to the interior of device **100** and block out all other frequencies. In at least some other embodiments, EMI filter **200** prevents the transmission of predetermined frequencies from the interior to the exterior of device **100**. In at least some embodiments, EMI filter **200** comprises at least two filters: one filter for positive voltage levels and one filter for negative voltage levels.

In at least some other embodiments, EMI filter **200** is positioned external of unit **118** and internal of device **100** and electrically coupled to the generation and suppression unit. In

still further embodiments, EMI filter **200** may be positioned external of or partially external of device **100** and electrically coupled to unit **118**.

Noise generator **202** generates audio noise signals to the interior of device **100** via one or more audio transducers, i.e., speaker **208**. Noise generator **202** generates audio noise via speaker **208** to prevent an electronic device positioned within receiving compartment **105** from recording audio signals originating exterior of device **100**. In at least some embodiments, noise generator **202** is a random noise generator (e.g., a pink or white noise generator) which uses the random thermal electronic noise of a semiconductor p-n junction as the source for the random noise. The electronic noise signal is then filtered and amplified for transmission by speaker **208**.

In at least some embodiments, device **100** and/or unit **118** may comprise one or more speakers **208** positioned within the interior of the device. In at least some embodiments, speaker **208** may be positioned in lid **102** and/or base **104** and be driven to a sufficient level to provide a masking noise signal to internally positioned electronic devices in device **100** in a closed position. Speaker **208** may be positioned in lid **102** toward the center above a predetermined location in which one or more electronic devices may be positioned.

In at least some embodiments, the noise signal delivered to speaker **208** has a maximum amplitude of +4 dBm at approximately 630 Hertz (Hz), and a flatness of +/-0.5 dB from 87 Hz to 4 kHz. The lower corner frequency (-3 dB point) of the emission band is at approximately 47 Hz, and the upper corner frequency (-3 dB point) is at approximately 8 kHz according to at least some embodiments. At the limits of the human hearing range 20 Hz-20 kHz, the signal amplitudes are -5.5 dBm and -4.7 dBm, respectively.

In at least some embodiments, generation and suppression unit **118** also comprises seal detector **204** which comprises a switch mechanism arranged in conjunction with lid **102** to detect closure of the lid of device **100**, i.e., seal detector indicates that the device is in a closed position. Seal detector **204** may be electrically coupled with noise generator **202** to receive power for operation. Seal detector **204** is cooperatively coupled with noise generator **202** to transmit a signal indicating the closure state of device **100**. After detection of device **100** in closed position, seal detector **204** transmits a signal to noise generator **202** to cause activation of the noise generator to generate the noise signal via speaker **208**.

In at least some embodiments, seal detector **204** comprises a part of lid **102** and/or base **104** exterior to unit **118**. In at least some embodiments, the switch mechanism of seal detector **204** may comprise a tab attached to or formed as a part of lid **102** which contacts a switch upon closure of device **100**. In at least some embodiments, the switch mechanism may comprise electrical, optical, mechanical, or other manner of detecting closure of device **100**. In at least some other embodiments, upon detection of opening of device **100**, seal detector **204** transmits a signal to noise generator **202** to cause termination of charging current supply to charging connector **122** via EMI filter **200**.

Generation and suppression unit **118** also comprises alarm unit **206** electrically and communicatively coupled to noise generator **202**. Alarm unit **206** comprises a timer to determine whether device **100** has been left in an open state for a predetermined period of time. For example, if alarm unit **206** fails to receive a signal from seal detector **204** (via noise generator **202**) within the predetermined period of time indicating closure of device **100**, the alarm unit generates an alarm. After the predetermined period of time has been reached, alarm unit **206** generates an alarm to indicate that device **100** has remained in an open state for an excessive

5

amount of time. Alarm unit 206 may generate an audible and/or visual alarm signal. In at least some embodiments, alarm unit 206 may be directly coupled with speaker 208 to cause the speaker to generate the audible alarm signal. In at least some embodiments, alarm unit 206 may form part of noise generator 202.

In at least some embodiments, the timer comprises a series of capacitors charged at a predetermined rate based on power received from EMI filter 200. After the capacitors reach a saturation point, the excess voltage is transmitted to the alarm, and the alarm sounds, e.g., the excess voltage may be transmitted to speaker 208.

In at least some embodiments, alarm unit 206, and seal detector 204 may be electrically coupled with EMI filter 200 and communicatively coupled with noise generator 202.

FIG. 3 depicts another embodiment of device 100 wherein unit 118 comprises EMI filter 200, noise generator 202, charging connector 122, speaker 208, and a seal detector 300 similar to the seal detector of FIG. 2. Seal detector 300, however, comprises alarm unit 206 as a part of the seal detector.

FIG. 4 depicts another embodiment of device 100 wherein unit 118 comprises EMI filter 200, noise generator 202, charging connector 122, speaker 208, seal detector 204, and an alarm unit 400 similar to the alarm unit of FIG. 2. Alarm unit 400, however, comprises a battery 402 in order to enable operation of alarm unit for a predetermined period of time after loss of power from EMI filter 200 to the alarm unit. In this manner, alarm unit 400 may operate to indicate an alarm based upon loss of power to device 100 and/or loss of power to noise generator 202. In operation, alarm unit 400 monitors the power supply from EMI filter 200 (via noise generator 202) and, based upon a determination of loss of power from the EMI filter, causes the generation of an alarm signal. In at least some embodiments, the alarm signal may be generated by alarm unit 400, a speaker (e.g., speaker 208) or other signal generator integrated as part of alarm unit, or a speaker or other signal generator external to device 100.

FIG. 5 depicts another embodiment of device 100 further comprising an additional charging connector 500 connected with EMI filter 200. In at least some embodiments, more than two charging connectors may be connected with EMI filter 200 in order to supply charging power to electronic devices inside device 100.

FIG. 6 depicts a high-level process flow of at least a portion 600 of operation of device 100 according to an embodiment. In at least some embodiments, portion 600 may comprise a set of instructions to be executed by noise generator 202. In at least some other embodiments, portion 600 may comprise a set of instructions to be executed by a controller or other processor or logic device of device 100. The set of instructions may be stored in volatile and/or non-volatile memory comprising a part of device 100. At device open state 602, device 100 is in an open state available to receive an electronic device. At device closed state 604, device 100 is in a closed state and noise generator 202 is operating to generate a noise signal.

Given an initial operating state of device 100 in an open state 602, the flow begins at timer running functionality 606 and a timer is counting a period of time during which the device is in the open state. An electronic device is placed within the interior of the device in open state 602.

After a predetermined period of time has elapsed, the timer times out and the flow proceeds to generate alarm functionality 608 and device 100 generates an alarm signal to indicate to a user that the device has been open for longer than the predetermined amount of time. If a user then closes device

6

100, the flow proceeds to device closed state 604 and generate noise signal functionality 610 operates to cause the generation of the noise signal interior to the device. As described above, the device closed state 604 may be detected by seal detector 204 (FIG. 2).

If, however, the predetermined period of time has not elapsed and device 100 is closed, the flow transitions to device closed state 604 and generate noise signal functionality 610 operates to cause the generation of a noise signal interior to the device. As described above, the device closed state 604 may be detected by seal detector 204 (FIG. 2).

After transitioning to the device closed state 604, if the device is opened, e.g., as detected by seal detector 204 (FIG. 2), the flow proceeds to device open state 602 and the timer is restarted in timer running functionality 606.

FIG. 7 depicts another perspective view of device 100 according to an embodiment. FIG. 7 depicts a pair of speakers 700 (similar to speaker 208) mounted in lid 102 of device 100. As depicted, FIG. 7 also depicts a piston 702 biased to nominally maintain device 100 in an open position. Piston 702 is mounted at one end to lid 102 and at the other end to base 104. In at least some embodiments, device 100 comprises more than one piston and more or less numbers of speakers.

FIG. 7 also depicts an upper portion of an isolation material 704 positioned within lid 102 for receiving electronic device 120 and further isolating the device from audio signals from exterior of device 100. Upper portion 704 and lower portion 128 (FIG. 1) are constructed to form an enclosing unit after device 100 is in a closed state.

FIG. 8 depicts another perspective view of device 100 according to an embodiment in a closed state. Latch 124 is caught on catch 126 maintaining device 100 closed, e.g., against the normally open action of piston 702 (FIG. 7).

What is claimed is:

1. An anti-eavesdropping device, comprising:
 - a receiving compartment comprising a base and a lid and being arranged to receive an electronic device therein, wherein the receiving compartment is arranged to minimize signal transmissions from the exterior to the interior and from the interior to the exterior;
 - a noise generator coupled within the receiving compartment; and
 - an electromagnetic signal filter coupled with the receiving compartment and operatively coupled with the noise generator.
2. The device of claim 1, further comprising a power cable electrically coupling the device with a power source.
3. The device of claim 1, further comprising a seal detector electrically coupled with the electromagnetic signal filter and arranged to generate a signal indicating a state of the device.
4. The device of claim 3, wherein the seal detector is arranged to generate a signal indicating whether the device is in an open state.
5. The device of claim 3, further comprising:
 - an alarm unit electrically coupled with the electromagnetic signal filter and arranged to generate an alarm signal a predetermined time after detection of the device in an open state.
6. The device of claim 1, wherein the noise generator is arranged to generate a noise signal during a time period of the device being in a closed state.
7. The device of claim 6, wherein the noise generator comprises at least one speaker arranged to generate the noise signal.
8. The device of claim 6, wherein the noise generator comprises at least one speaker arranged to generate the noise

7

signal and wherein the at least one speaker is positioned adjacent the electronic device.

9. The device of claim 6, wherein device comprises a speaker corresponding to each electronic device to be received by the device.

10. The device of claim 9, wherein the noise generator is coupled to each speaker.

11. The device of claim 1, wherein the device is electromagnetically shielded.

12. The device of claim 1, wherein the receiving compartment is further arranged to minimize electromagnetic signal transmissions comprising at least one of a radio frequency signal, an acoustic signal, or an optical signal.

13. The device of claim 1, wherein the electromagnetic signal filter is arranged to supply a charging current for the electronic device.

14. The device of claim 1, further comprising:
at least one charging connector arranged to electrically couple the electromagnetic signal filter to the electronic device.

15. The device of claim 1, further comprising an alarm unit arranged to generate an alarm signal responsive to the device being in an open state.

16. The device of claim 15, wherein the alarm unit is arranged to generate an alarm signal responsive to the device being in an open state for a predetermined period of time.

17. An storage device for one or more electronic devices, comprising:
a base;
a lid openable and attachable to the base;
the base and lid defining a compartment into/from which an electronic device is placed/removed, in a closed state the compartment being arranged to minimize signal transmissions between the exterior and the interior;
a noise generator couplable with at least one of the base or the lid and positioned within the compartment; and

8

an electromagnetic signal filter coupled with at least one of the base or the lid and operatively coupled with the noise generator for minimizing signal transmissions to/from the noise generator.

18. The electronic device storage device as claimed in claim 17, further comprising a power cable electrically coupled with the electromagnetic signal filter and arrange to electrically couple with a power source.

19. The electronic device storage device as claimed in claim 17, wherein the noise generator is arranged to generate a noise signal during a time period of the device being in a closed state and to not generate the noise signal during a time period of the device being in an open state.

20. The electronic device storage device as claimed in claim 17, further comprising a hinge attaching the lid to the base.

21. The electronic device storage device as claimed in claim 17, wherein the defined compartment forms an electromagnetically shielded compartment.

22. An electronic signal transmission minimizing device, comprising:
a base;
a lid movably attached to said base;
said base having a peripheral edge bounding an opening for access to a compartment defined between said lid and said base in an interior of said device;
said compartment is configured to minimize signal transmission between said interior and an exterior of said device if said lid and said base are in a closed position relative to one another;
a noise generator couplable with at least one of the base or the lid and positioned within the compartment; and
an electromagnetic signal filter coupled with at least one of the base or the lid and operatively coupled with the noise generator for minimizing signal transmission to/from the noise generator.

* * * * *